

E Finding Area

Mr. Washington is painting the basement floor. He made a drawing of the floor.

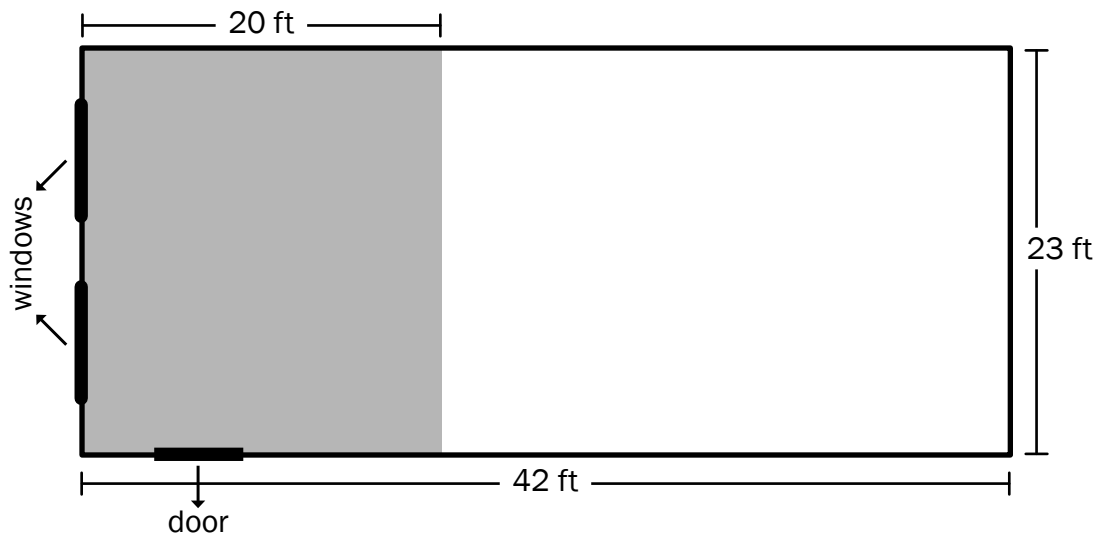

- A. Find the area of the whole basement floor. Write a number sentence to show how you know.
- B. Mr. Washington started painting by the windows and painted 20 feet into the room before lunch. How many square feet did he paint before lunch? Write a number sentence to show how you know.
- C. How many square feet were left to paint after lunch? Show or tell how you know.